

FORZA 

**Self-centering
Machine Vice
24 Series**

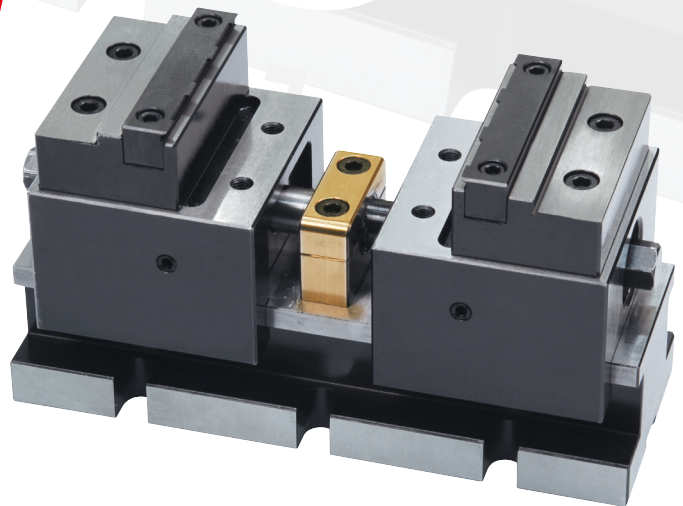

24 serie Self-centering

ÍNDEX

1. Technical features	3
2. Machine vice positions	3
3. Reversible Jaws	5
4. Clamping Force	5
5. Exploded views	6



■ 1. TECHNICAL FEATURES

Made from case-hardening treatment material DIN 14CrMo13 (F155)

Body and jaw-holder with Hardness 60HRc.

Fully grinded.

Measure D with **g7** finishing allowance.

Guided jaw-support.

The jaws-holder have 2 anchoring positions.

The mouths are reversible and have spikes on one side.

The spindle's central support is from bronze.

Trapezoidal threaded spindle

The jaw-holder are guided

■ 2. MACHINES VICE POSITIONS

24/75 The jaw-holder has two anchoring positions the jaw-holder.

- The opening at position 1 is 12mm to 60mm and 60 to 110mm.
- The opening at position 2 is 60mm to 110mm and 110 to 155mm

Position 1

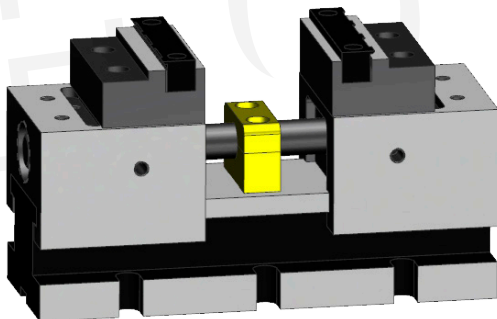

Position 2

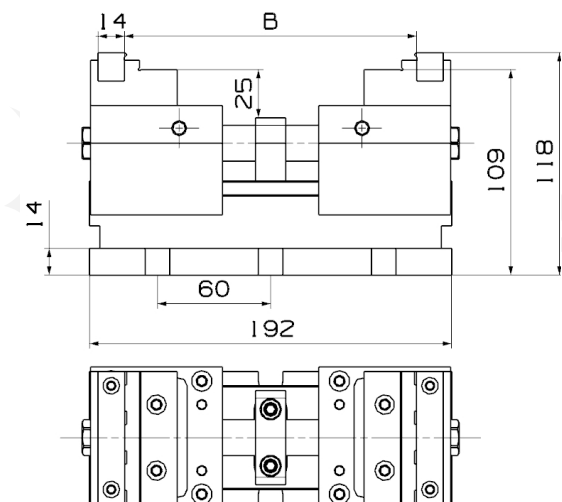
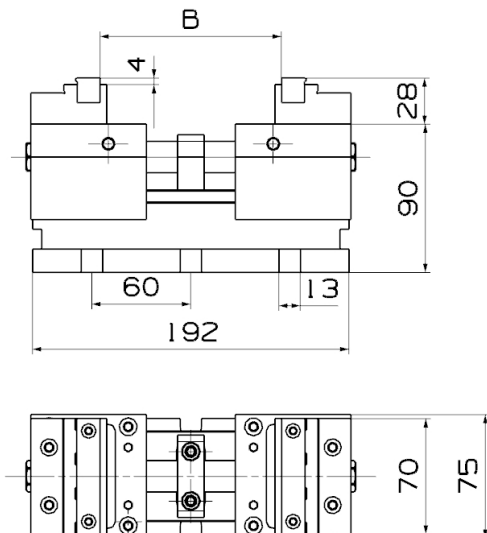
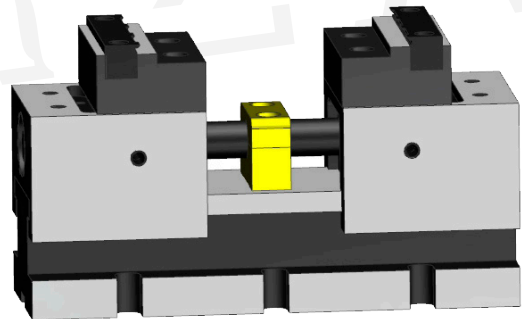

24/95 The jaw-holder has two anchoring positions the jaw-holder.

- The opening at position 1 is 20mm to 80mm and 80mm to 140mm.
- The opening at position 2 is 80mm to 140mm and 140mm to 200mm.

Position 1

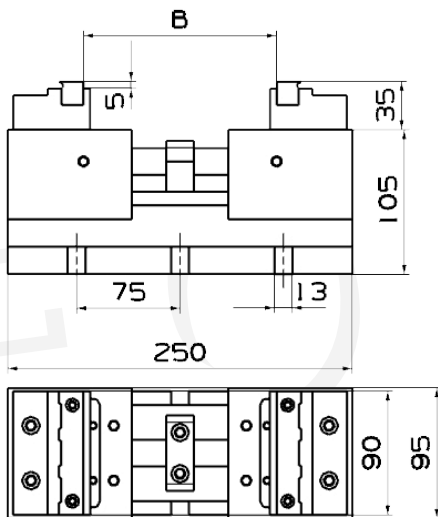
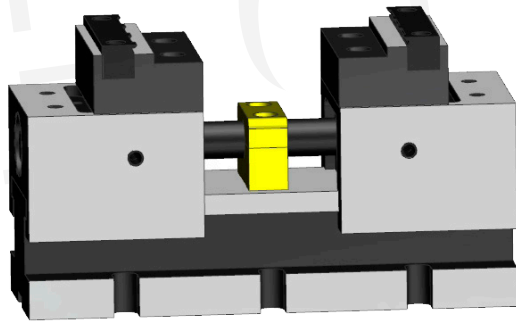

Position 2

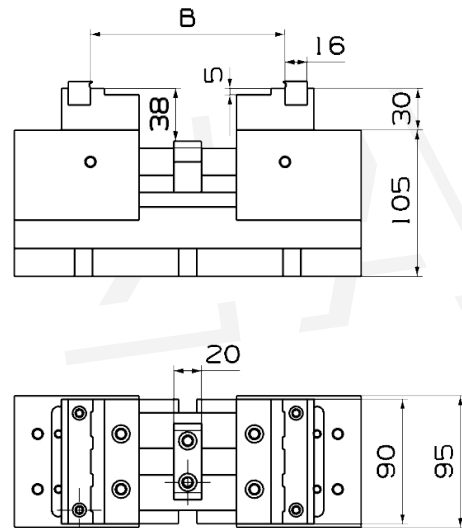
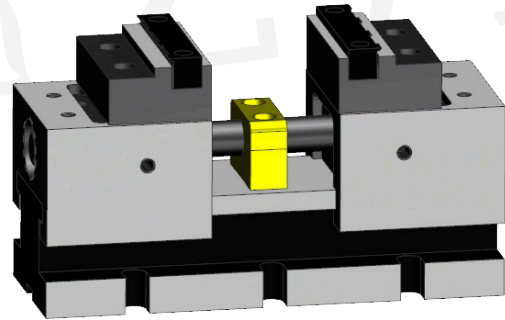

24/100 The jaw-holder has two anchoring positions the jaw-holder.

- The opening at position 1 is 45 to 105mm, 105 to 265mm and 265 to 285mm.
- The opening at position 2 is 105 to 165mm, 165 to 225mm and 225 to 345mm.

Position 1

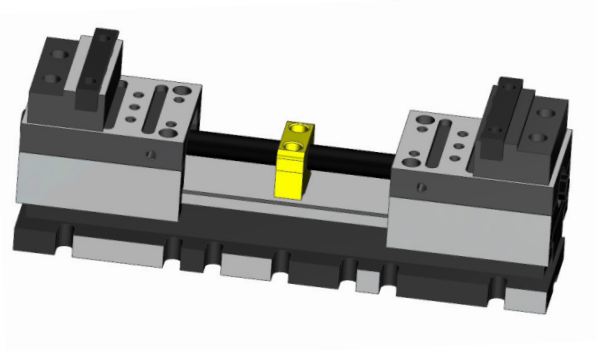

Position 2

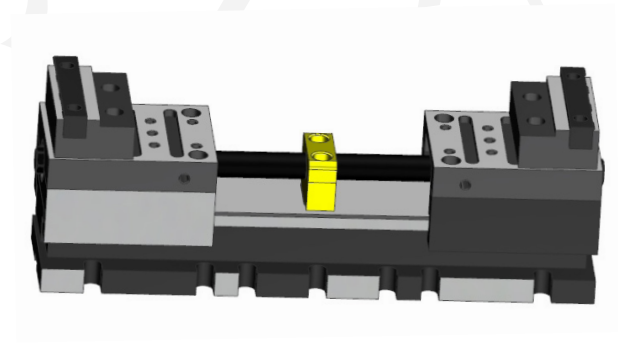

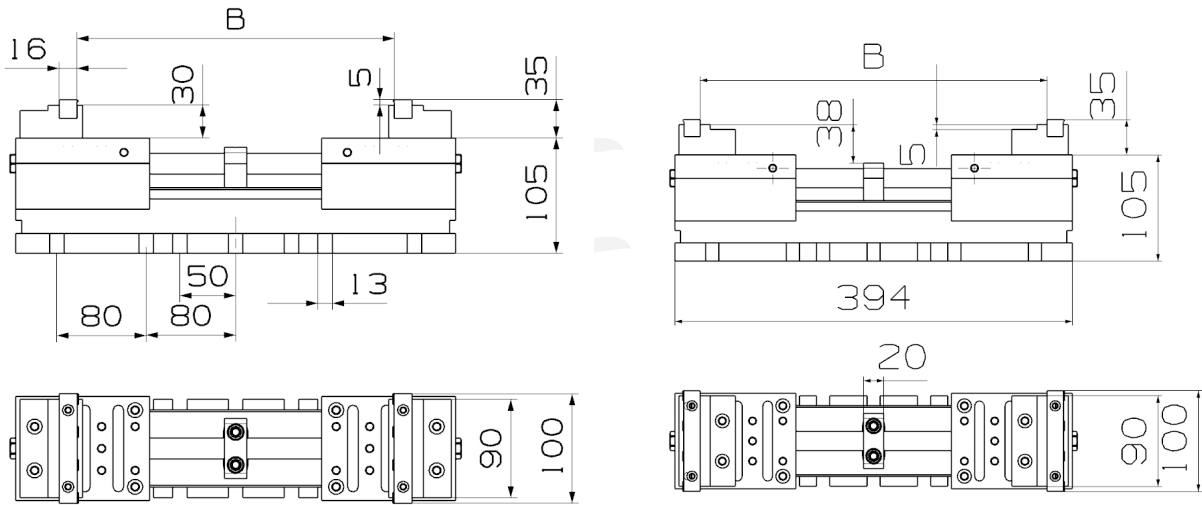

■ **3. REVERSIBLE JAWS**

This clamp is equipped with reversible mouths. These are flat on one side and with mordants the other.



■ **4. CLAMPING FORCE**

This machine vice in normal working conditions has a clamping force of **2 tons**.

■ 5. 24 SERIE EXPLODED VIEWS

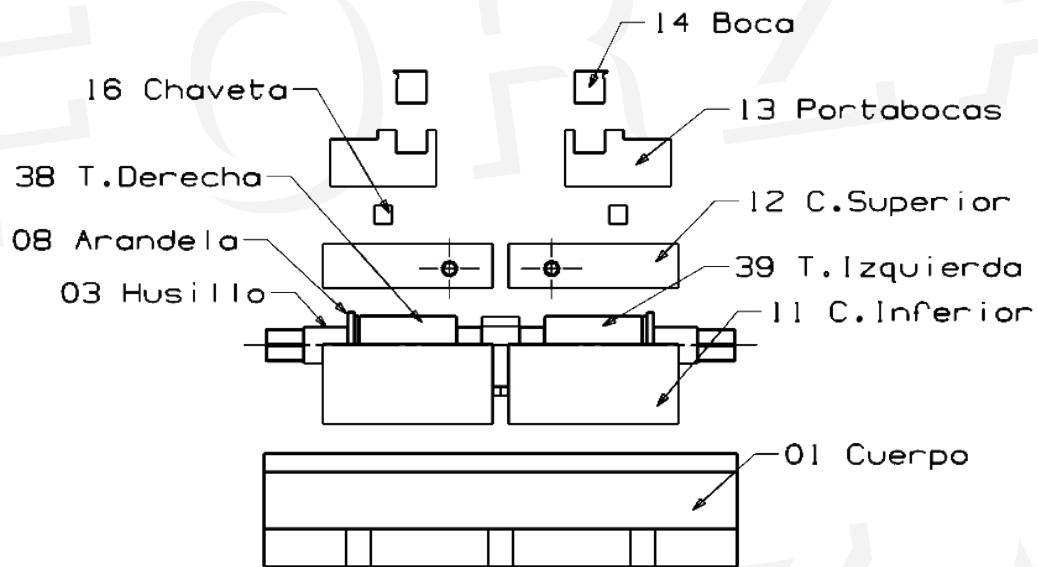



S.L. de Herramientas Especiales Forza
C/ San Miguel de Atxa, 24
01010 Vitoria
www.forza.es

